

PPS - Tubo di collegamento blu curvato



| | | | |
|--|---|---|--|
| <p><u>Tubo Ø est. (mm)</u></p> <p>16</p> | <p><u>Tecnologia</u></p> <p>PPS Grip Concept</p> | <p><u>Pressione di utilizzo</u></p> <p>0 a 16 bar</p> | <p><u>Depressione</u></p> <p>-0.98 bar (vuoto 98%)</p> |
| <p><u>Temperatura</u></p> <p>-20°C a +80°C</p> | <p><u>Materiale</u></p> <p>Tubo e raccordi: alluminio</p> | <p><u>Vantaggio</u></p> <p>Sistema in continua evoluzione</p> | <p><u>Conforme alle normative</u></p> <p>PED REACH</p> |

Descrizione

Riferimento

Tubo Ø est. (mm)

| | |
|-------------------|----|
| PPS LMCB16 | 16 |
| PPS LMCB20 | 20 |
| PPS LMCB25 | 25 |

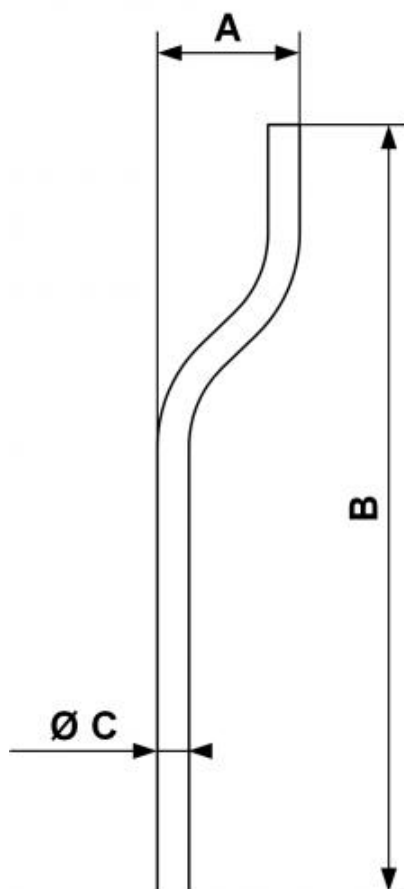

Dimensions

| Riferimento | A mm | B mm | C mm |
|-------------------|------|------|------|
| PPS LMCB16 | 86 | 480 | 16 |
| PPS LMCB20 | 90 | 487 | 20 |
| PPS LMCB25 | 95 | 487 | 25 |